



**RECEIVED**

By Division of Waste Management and Radiation Control at 4:15 pm, Jul 11, 2022

Deq submit <dwmrcsubmit@utah.gov>

## Permit Application for Plain City Landfill

1 message

**Matt Sullivan** <msullivan@utah.gov>

Mon, Jul 11, 2022 at 3:54 PM

To: Deq submit <dwmrcsubmit@utah.gov>

Attached is the Permit Application that Plain City submitted today, July 11, 2022, for the Plain City Landfill. SW170

--

Matt Sullivan | Environmental Scientist

Solid Waste Program, Division of Waste Management & Radiation Control

Email: [msullivan@utah.gov](mailto:msullivan@utah.gov)

Office: (801) 536-0241 | Front Desk: (801) 536-0200

*Emails to and from this email address may be considered public records and thus subject to Utah GRAMA requirements.*

*Statements made in this email do not constitute the official position of the Director of the Division of Waste Management and Radiation Control. If you desire a statement of the Division Director's position, please [submit a written request to the Director](#), including copies of documents relevant to your request.*



**Application - July 11, 2022.pdf**

6227K

# **Solid Waste Permit Renewal Application**

Plain City Corporation  
July 5, 2022

## Utah Class IV and VI Landfill Permit Application Form

|   |  |   |  |   |  |
|---|--|---|--|---|--|
| <b>Part I General Information</b>   |  | APPLICANT: PLEASE COMPLETE ALL SECTIONS.      |  |   |  |
| <b>I. Landfill Type</b>   | <input checked="" type="checkbox"/> Class IVa<br><input type="checkbox"/> Class VI | <input checked="" type="checkbox"/> Class IVb | <b>II. Application Type</b>                                  | <input type="checkbox"/> New Application<br><input checked="" type="checkbox"/> Renewal Application | <input type="checkbox"/> Facility Expansion<br><input type="checkbox"/> Modification |
| For Renewal Applications, Facility Expansion Applications and Modifications Enter Current Permit Number <span style="float: right;">9402R1</span> |  |   |  |   |  |
| <b>III. Facility Name and Location</b>  |  |   |  |   |  |
| Name of Facility<br><i>Plain City Landfill</i>  |  |   |  |   |  |
| Site Address (street or directions to site)<br><i>5100 W 2700N</i>  |  |   |  | County<br><i>Weber</i>  |  |
| City<br><i>Plain City</i>   |  | Zip Code<br><i>84404</i>                      |  | Telephone<br><i>731-4908 (801)</i>  |  |
| Township  | Range  | Section(s)                                    | Quarter/Quarter Section                                      | Quarter Section   |  |
| Main Gate Latitude  | degrees  | minutes                                       | seconds  | Longitude   | degrees  |
|   |  |   |  |   | minutes  |
|   |  |   |  |   | seconds  |
| <b>IV. Facility Owner(s) Information</b>  |  |   |  |   |  |
| Name of Facility Owner<br><i>Plain City Corporation</i>   |  |   |  |   |  |
| Address (mailing)<br><i>4160 W 2200 N</i>   |  |   |  |   |  |
| City<br><i>Plain City</i>   |  | State<br><i>UT</i>                            |  | Zip Code<br><i>84404</i>  |  |
| Telephone<br><i>801-731-4908</i>  |  |   |  |   |  |
| <b>V. Facility Operator(s) Information</b>  |  |   |  |   |  |
| Name of Facility Operator<br><i>Christopher Weicks</i>  |  |   |  |   |  |
| Address (mailing)<br><i>4160 W 2200N</i>  |  |   |  |   |  |
| City<br><i>Plain City</i>   |  | State<br><i>UT</i>                            |  | Zip Code<br><i>84404</i>  |  |
| Telephone<br><i>801-731-4908</i>  |  |   |  |   |  |
| <b>VI. Property Owner(s) Information</b>  |  |   |  |   |  |
| Name of Property Owner<br><i>Plain City Corporation</i>   |  |   |  |   |  |
| Address (mailing)<br><i>4160 W 2200N</i>  |  |   |  |   |  |
| City<br><i>Plain City</i>   |  | State<br><i>UT</i>                            |  | Zip Code<br><i>84404</i>  |  |
| Telephone<br><i>801-731-4908</i>  |  |   |  |   |  |
| <b>VII. Contact Information</b>   |  |   |  |   |  |
| Owner Contact   |  |   | Title  |   |  |
| Address (mailing)   |  |   |  |   |  |
| City  |  | State   |  | Zip Code  |  |
|   |  |   |  | Telephone   |  |
| Email Address   |  |   | Alternative Telephone (cell or other)                        |   |  |
| Operator Contact<br><i>Christopher Weicks</i>   |  |   | Title<br><i>Landfill Director</i>                            |   |  |
| Address (mailing)<br><i>4160 W 2200N</i>  |  |   |  |   |  |
| City<br><i>Plain City</i>   |  | State<br><i>UT</i>                            |  | Zip Code<br><i>84404</i>  |  |
|   |  |   |  | Telephone<br><i>801-731-4908</i>  |  |
| Email Address   |  |   | Alternative Telephone (cell or other)<br><i>801-979-4659</i> |   |  |
| Property Owner Contact  |  |   | Title  |   |  |
| Address (mailing)   |  |   |  |   |  |
| City  |  | State   |  | Zip Code  |  |
|   |  |   |  | Telephone   |  |
| Email Address   |  |   | Alternative Telephone (cell or other)                        |   |  |

## Utah Class IV and VI Landfill Permit Application Form

**Part I General Information (Continued)**

**VIII. Waste Types** (check all that apply)

Landfill will accept all wastes allowed in Class IV or VI landfills Or landfill will accept only the following wastes

|   |                          |                          |
|---|--------------------------|--------------------------|
| Waste Type  | Combined Disposal Unit   | Monofill Unit            |
| <input checked="" type="checkbox"/> Construction & Demolition | <input type="checkbox"/> | <input type="checkbox"/> |
| <input type="checkbox"/> Tires                                | <input type="checkbox"/> | <input type="checkbox"/> |
| <input checked="" type="checkbox"/> Yard Waste                | <input type="checkbox"/> | <input type="checkbox"/> |
| <input type="checkbox"/> Animals                              | <input type="checkbox"/> | <input type="checkbox"/> |
| <input type="checkbox"/> Contaminated Soil                    | <input type="checkbox"/> | <input type="checkbox"/> |
| <input type="checkbox"/> Other _____                          | <input type="checkbox"/> | <input type="checkbox"/> |

Note: Disposal of dead animals must be approved by the Director

**IX. Facility Area**

|                    |               |       |
|--------------------|---------------|-------|
| Facility Area..... | <u>15</u>     | acres |
| Disposal Area..... | <u>5</u>      | acres |
| Design Capacity    |               |       |
| Years.....         | <u>30</u>     |       |
| Cubic Yards.....   | <u>84,000</u> |       |
| Tons.....          | <u>42,000</u> |       |

**X. Fee and Application Documents**

|  |  |   |
|--|--|---|
| Indicate Documents Attached To This Application          | <input type="checkbox"/> Application Fee: Amount \$            | Class VI Special Requirements   |
| <input checked="" type="checkbox"/> Facility Map or Maps | <input checked="" type="checkbox"/> Facility Legal Description | <input type="checkbox"/> Documents required by UCA 19-6-108(9) and (10) |
| <input type="checkbox"/> Ground Water Report             | <input checked="" type="checkbox"/> Closure Design             |   |
|  | <input checked="" type="checkbox"/> Plan of Operation          |   |
|  | <input checked="" type="checkbox"/> Cost Estimates             |   |
|  | <input checked="" type="checkbox"/> Waste Description          |   |
|  | <input checked="" type="checkbox"/> Financial Assurance        |   |

I HEREBY CERTIFY THAT THIS INFORMATION AND ALL ATTACHED PAGES ARE CORRECT AND COMPLETE.

|   |                                       |                   |          |
|---|---------------------------------------|-------------------|----------|
| Signature of Authorized Owner Representative                      |                                       | Title             | Date     |
|   |                                       | Mayor             | 7/8/22   |
| Name typed or printed   |                                       | Address           |          |
| Son D Beesley   |                                       | 2348 N. 4350 W.   |          |
| Email Address   | Alternative Telephone (cell or other) |                   |          |
|   |                                       |                   |          |
| Signature of Authorized Land Owner Representative (if applicable) |                                       | Title             | Date     |
|   |                                       |                   |          |
| Name typed or printed   |                                       | Address           |          |
|   |                                       |                   |          |
| Email Address   | Alternative Telephone (cell or other) |                   |          |
|   |                                       |                   |          |
| Signature of Authorized Operator Representative (if applicable)   |                                       | Title             | Date     |
|   |                                       | Landfill Director | 7/8/2022 |
| Name typed or printed   |                                       | Address           |          |
| Christopher Weck  |                                       | 4487W 1975N.      |          |
| Email Address   | Alternative Telephone (cell or other) |                   |          |
|   |                                       |                   |          |

## 1.0 General Description

The Plain City Landfill will have an active area of 1 acre. It is sectioned off by clay berms into an area of 1320 feet long and 180 feet wide with the berms being 20 feet in height presently. These clay berms will contain the waste and act as a fire barrier.

The landfill will accept only construction and or demolition and yard waste. This would include waste such as vegetative matter generated from yards, parks and gardens. It would also include waste from building material, packaging and rubble resulting from construction, remodeling, repair and demolition operations on pavements, houses, commercial building and other structures as stated in the Proposed Solid Waste Rules. This waste would exclude all household waste such as any garbage, trash, or sanitary waste, plastics, chemicals or chemical containers. All waste that is rejected or not accepted will be taken to the Weber County transfer station by the user.

## 2.0 Legal Description and Proof of Ownership

See Warranty Deed.

## 3.0 Plan of Operation

The Class IVb Landfill is already in place and is able to accept waste. This landfill accepts small amounts of wastes and will be open two days a week. Wednesdays from 5-7 pm and Saturdays from 8-3 pm. During periods when this facility is not able to allow for the disposal of waste, it can be redirected to the Weber County Transfer operation.

When the landfill is open there will be four to five operators. Two operators will be at the check in office where all loads will be thoroughly checked to make sure only yard and construction/demolition waste is admitted into the landfill. As stated earlier, any other waste will be turned away and referred to the Weber County Transfer Station. Two other operators will be assigned to the demolition pit and yard waste areas to further ensure that prohibited materials are not dumped. One other operator, at times, will be on hand to load compost/manure materials for users that desire these materials.

Training will be done on a quarterly basis. This training does or will include use of operative equipment such as front loaders and crawlers (safety measures included), crushing of materials and creating new space for future materials brought in by patrons, maintenance of operative equipment, extraction of illegal materials from demolition pit, brush piles and grass piles as needed, as well as emergency medical training in the event of an accident and/or other medical issues that may arise suddenly. Medical training will be conducted by EMTs of the Plain City Fire Department.

To prevent unauthorized dumping after hours or when an operator is not present, the entrance gate must and will be locked. Fencing surrounding the landfill must be maintained in order to control entry.

In the event of a fire, the Plain City Fire Department will be notified immediately. Clay material on site can be used to prevent or contain fires as directed by the Fire Marshall. This clay material can also be used to prevent any problems with the emission of fugitive dust.

1. Plain City Landfill has been in operation for years. It currently has in place buildings, roadways, separated product pods and a demolition pit. All roadways are hard packed and gravel topped to address fugitive dust. We have separated composting pods and brush piles. We also have separate recycling pods or bins for metals, certain plastics, cardboard and concrete.
2. Plain City Landfill uses a Daily Report form that lists the permit number of the person that deposited, what is being deposited and the volume of loads received.
3. Plain city Landfill has put into service a program to monitor and record the inspection of every load that is left and states the type of waste, the amount of waste and any waste that is rejected. A Landfill Inspection form is filled out quarterly. A training sheet is filled out quarterly and signed by all employees.
4. Plain City Landfill has constructed dirt berms to deal with fire problems in the demolition pit, thus enabling a quick extinguishment by firefighting personnel.
5. Plain City Landfill has black topped the road leading up to the entrance of the landfill, thereby, once again substantially limiting fugitive dust.
6. Plain City Landfill does not allow household garbage to be deposited at the landfill so we do not have a rat or mouse problem in the pit area. We do at times place household mouse control measures in our buildings.
7. If the need arises for alternative waste handling due to short term problems with the landfill, users will be directed to use the closest private site to dispose of Class IVb waste.
8. All landfill employees are given safety protocols on the use of equipment and general operational procedures.

9. Plain City Landfill does not accept dead animals.
10. Plain City Landfill has planted Crest Wheat Grass as well as dumping dirt and manure on the sides of the demolition pit berms to control run-on and run-off. When water gathers in certain places inside the landfill due to excessive rain, small channels are dug to run the water off into a ditch.

#### 4.0 Financial Assurance Plan

In a recent email from the State of Utah to Plain City Corporation concerning the Plain City Landfill Permit Renewal, it is required that Plain City Corporation draw up a plan to bring the Closure and Post Closure (PTIF) form in compliance with the updated, current costs.

The new figures to bring Plain City Landfill Closure and Post Closure costs up to date were calculated by Brad Jensen, Plain City's municipal engineer. It was calculated that the Closure cost would be \$142,000, with the Post Closure cost at \$69,575 for a total cost of \$211,500. Enclosed is a copy of Brad Jensen's refigured cost.

An option that Plain City Corporation has decided to implement is a 6 year plan to gradually bring the Closure and Post Closure (PTIF) costs into compliance.

Plain City Corporation has elected to bring these costs into compliance over a 6 year period. Plain City currently has \$61,578 in the PTIF. The amount of \$61,578 subtracted from the new overall cost of \$211,775 would bring a deficit of \$150,197. Therefore it is proposed by Plain City Corporation that approximately \$24,987 be added annually to the Closure and Post Closure (PTIF) costs over the next 6 years to bring Plain City Corporation into compliance with required costs. Since Plain City Corporation has already approved and passed a budget for the 22-23 fiscal year, deposits of \$25,032 annually into the PTIF will begin effectively with the 23-24 fiscal year. These deposits would be effective annually through the 28-29 fiscal budget.

#### 5.0 Closure Plan/Post Closure Plans

The remaining life capacity of the landfill space is approximately 84,000 cubic yards with a projected tonnage of 42,000 tons at roughly a ½ ton per yard. The total capacity and life of the landfill in terms of years or time is estimated to be 50 yrs.

The closure of each section will require the following steps:



1. A final cover will be installed over a minimum of 2 feet of clay soil. Surface of cover material will have to be graded to allow surface water to run off, but will not exceed 3 percent. Sides slopes will be less than 1 vertical to 3 horizontal. Compaction can be adequately accomplished by the excavation equipment.
2. Seeding of the upper layer with a grass suitable to the area's environment will be necessary to control erosion. Engineering and inspections will be required at the closure of each section.
3. The post closure plan for the Plain City Landfill includes the following:
  - Any structures that remain on site will be used for storage space of city equipment, supplies and vehicles to be maintained and monitored by city workers.
  - Semi annual site inspections specifically geared towards post closure maintenance will be conducted by either former landfill operators or city workers trained in in post closure procedures. These semi-annual inspections will be conducted for at least 30 years after the permanent closure of the Plain City Landfill.
  - Stabilization of settling soils, erosion repair and the application of soil cover to possible exposed solid waste will be remedied through the dispersion of copious amounts of fill dirt soil already on site.

## 6.0 Options

To reduce waste being put into the landfill and extend its life certain options are implemented. These would include separation of wastes such as lawn clippings, leaves, and other agricultural spoilage and the separation of recyclable materials.

### 6.1 Post Landscape Material

Yard waste composting is a low technology, low cost operation that diverts a large portion of the waste and turn it into a useful product. Post Landscaping Materials are both environmentally and economically beneficial to the community. Post Landscaping Materials are an aerobic degradation process of organic wastes. Volume of Post Landscaped Materials are reduced by as much as 75 percent.



A small section in the landfill's area is set aside for this process. Loads of grass clippings and leaves are diverted into this area. Berms 5 to 10 feet high are layered with this waste and turned periodically. After the waste turns to Post Landscaped Material it can be sold or given away to farmers and homeowners to improve the soil quality or post landscaping cover.

This low maintenance, low technology option is processed at a small cost to the landfill.

## 6.2 Source Separation

Bins set up at the landfill have given people in the community a place to bring recyclable materials. By finding markets for recyclable goods and educating the public about recycling a significant amount of the waste produced by the community will not need disposal.

Plain City Corporation  
 Landfill Closure Cost Estimate  
 May 31, 2022

| Item   | Description   | Quantity   | Unit Price  | Total               |
|--|---|------------|-------------|---------------------|
| 1  | Rough Grading / Misc. Excavation / Misc. Closure Preparation Work | 1 L.S.     | \$10,000.00 | \$10,000.00         |
| 2  | Place 2-foot Cap on Landfill (Stockpiled Material)                | 10000 Tons | \$6.50      | \$65,000.00         |
| 3  | Rough and Fine Grading  | 7,700 S.Y. | \$3.50      | \$26,950.00         |
| 4  | Seeding   | 7,700 S.Y. | \$1.50      | \$11,550.00         |
| 5  | Erosion Control and Site Stabilization                            | 1 L.S.     | \$5,000.00  | \$5,000.00          |
| <b>Project Subtotal</b>                                  |   |            |             | <b>\$118,500.00</b> |
| <b>Contingency, Engineering &amp; Project Management</b> |   |            |             | <b>\$23,700.00</b>  |
| <b>Total Estimated Project Cost</b>                      |   |            |             | <b>\$142,200.00</b> |

**Notes**

**1. Cap Material:** Currently, fill material is obtained from City Owned and Private Construction Projects. Currently, sufficient fill material is received and stockpiled to cap areas of the landfill as required.

**2. Estimated Costs:** Costs indicated herein are based on current construction and material prices. Costs have been increased in anticipation of increases for the short term. These costs are variable and should be updated regularly

**3. Run-on and run-off**

- a. landfill area will be surrounded by a ditch/swale that will collect any water or sediment before it is transported off the site.
- b. A small berm will be placed outside of the ditch/swale to prevent run-on
- c. Periodic Inspections will be conducted to identify and repair damage due to erosion.

**4. Closure Procedure**

- a. Notify Regulatory Agency to determine Current Inspection Requirements and Notifications
- b. Rough Grade Existing Surface
- c. Determine Existing Surface Elevations with Topographic Survey
- d. Place and Compact 2-foot Thick Soil Cap as Required (in locations where a cap has not previously been placed)
- e. Fine Grade Cap
- f. Install and Construct Drainage Ditches, Swales, Berms, Drainage Control Features
- g. Verify New Surface with Topographic Survey
- h. Conduct Final Inspection with Regulatory Agency

**Plain City Corporation**  
**Landfill Post Closure Cost Estimate**  
**May 31, 2022**

| Item                                | Description   | Quantity | Unit Price | Total              |
|-------------------------------------|---|----------|------------|--------------------|
| 1                                   | Annual Inspection (2 times Annually for 30 years)               | 30 Each  | \$500.00   | \$15,000.00        |
| 2                                   | Annual Reports and Record Keeping (30 years)                    | 30 Each  | \$375.00   | \$11,250.00        |
| 3                                   | Topographic Survey (every 3 years for 30 years)                 | 10 Each  | \$1,200.00 | \$12,000.00        |
| 4                                   | Annual Repair (cap, fence, erosion, every 3 years for 30 years) | 10 Each  | \$2,500.00 | \$25,000.00        |
| <b>Project Subtotal</b>             |   |          |            | <b>\$63,250.00</b> |
| <b>10% Contingency</b>              |   |          |            | <b>\$6,325.00</b>  |
| <b>Total Estimated Project Cost</b> |   |          |            | <b>\$69,575.00</b> |

**Notes:**

**Estimated Costs:** Costs indicated herein are based on current construction and material prices. Costs have been increased in anticipation of increases for the short term. These costs are variable and should be updated regularly.

## STATEMENT OF ACCOUNT

## PTIF

## UTAH PUBLIC TREASURERS' INVESTMENT FUND

Marlo M. Oaks, Utah State Treasurer, Fund Manager

PO Box 142315

350 N State Street, Suite 180

Salt Lake City, Utah 84114-2315

Local Call (801) 538-1042 Toll Free (800) 395-7665

www.treasurer.utah.gov

ESC-PLAIN CITY-LANDFILL  
 STEVE J DAVIS DEQ HW  
 4160 WEST 2200 NORTH  
 PLAIN CITY UT 84404

**Account****Account Period****6838**

May 01, 2022 through May 31, 2022

**Summary**

|                   |              |                       |              |
|-------------------|--------------|-----------------------|--------------|
| Beginning Balance | \$ 61,536.61 | Average Daily Balance | \$ 61,536.61 |
| Deposits          | \$ 41.98     | Interest Earned       | \$ 41.98     |
| Withdrawals       | \$ 0.00      | 360 Day Rate          | 0.7922       |
| Ending Balance    | \$ 61,578.59 | 365 Day Rate          | 0.8032       |

| <b>Date</b> | <b>Activity</b> | <b>Deposits</b> | <b>Withdrawals</b> | <b>Balance</b> |
|-------------|-----------------|-----------------|--------------------|----------------|
| 05/01/2022  | FORWARD BALANCE | \$ 0.00         | \$ 0.00            | \$ 61,536.61   |
| 05/31/2022  | REINVESTMENT    | \$ 41.98        | \$ 0.00            | \$ 61,578.59   |
| 05/31/2022  | ENDING BALANCE  | \$ 0.00         | \$ 0.00            | \$ 61,578.59   |

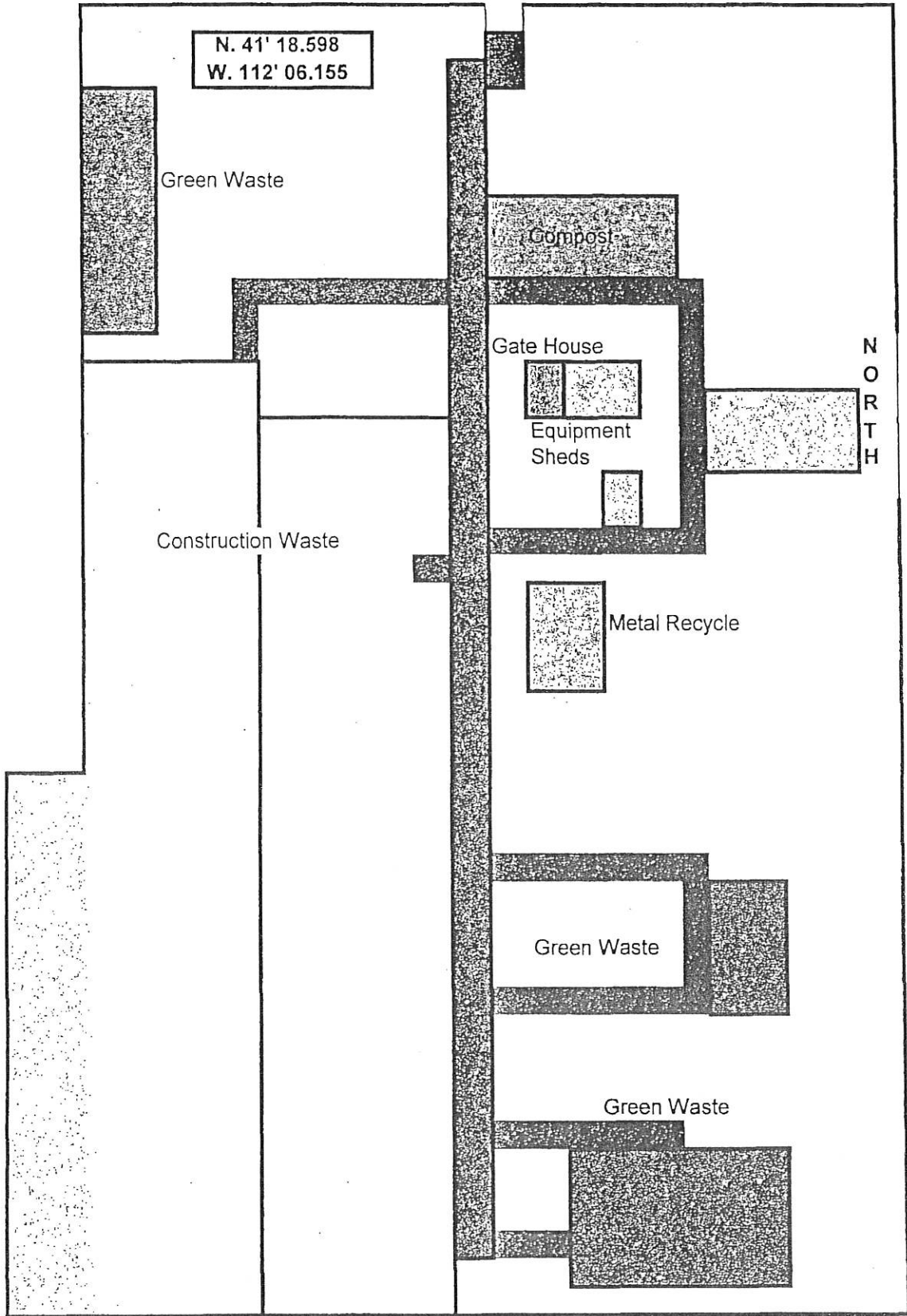

NOTE  
MATERIAL USED AS A FINAL COVER  
SHOULD HAVE A PERMEABILITY OF  
NO MORE THAN .0000001 cm./sec.

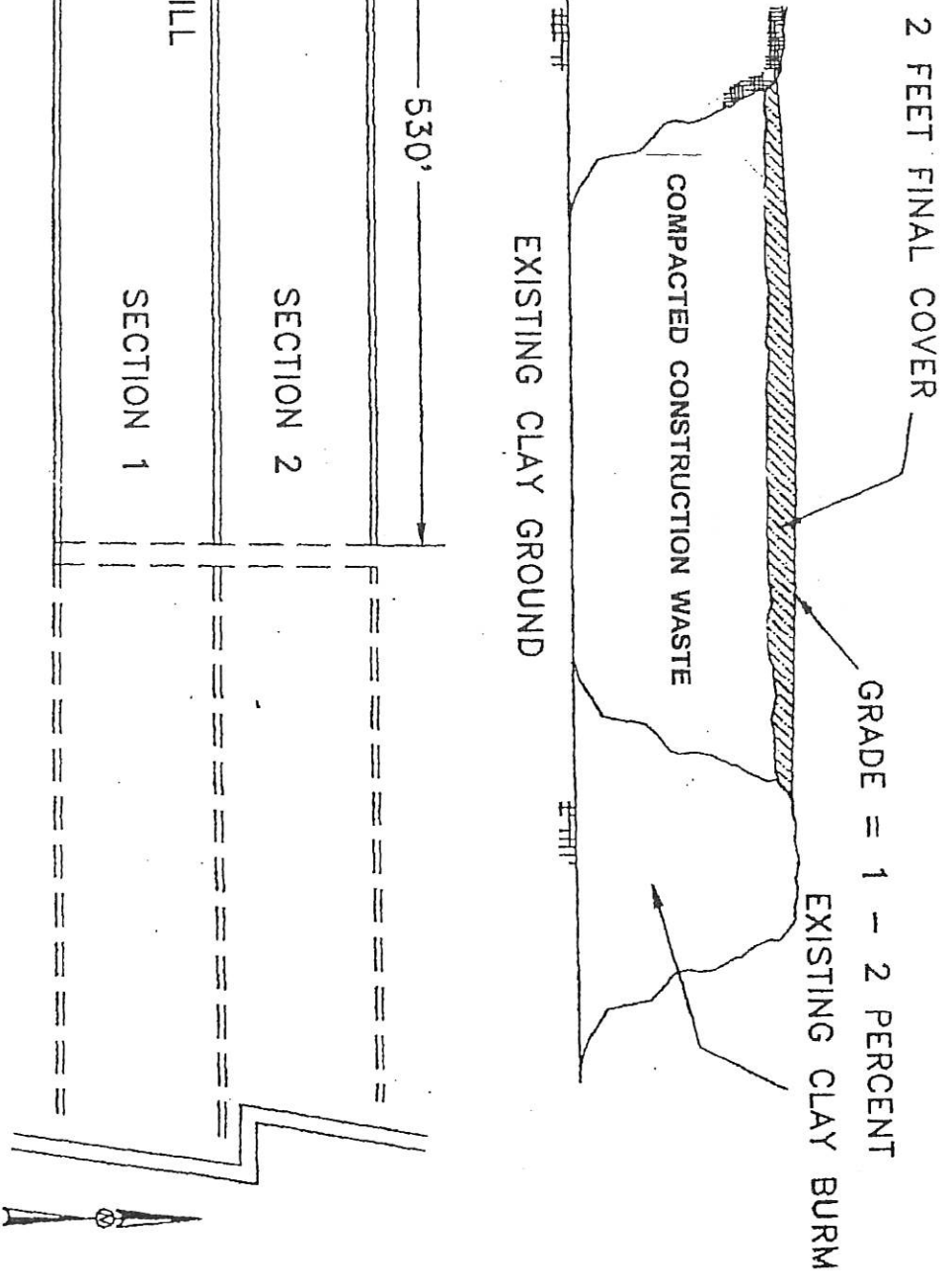

RR

REEVE & REEVE, INC.  
Civil and Environmental Engineering  
10000 West 10th Avenue  
Denver, Colorado 80201

PLAIN CITY

CLASS IV LANDFILL

1 1

# Plain City Zoning Map

Approved by the City Council on 11/10/09  
 Planning Commission on 10/20/09 and  
 Mayor on 11/10/09

Coordinates of Gate:  
 N. 41° 18.598  
 W. 112° 08.155

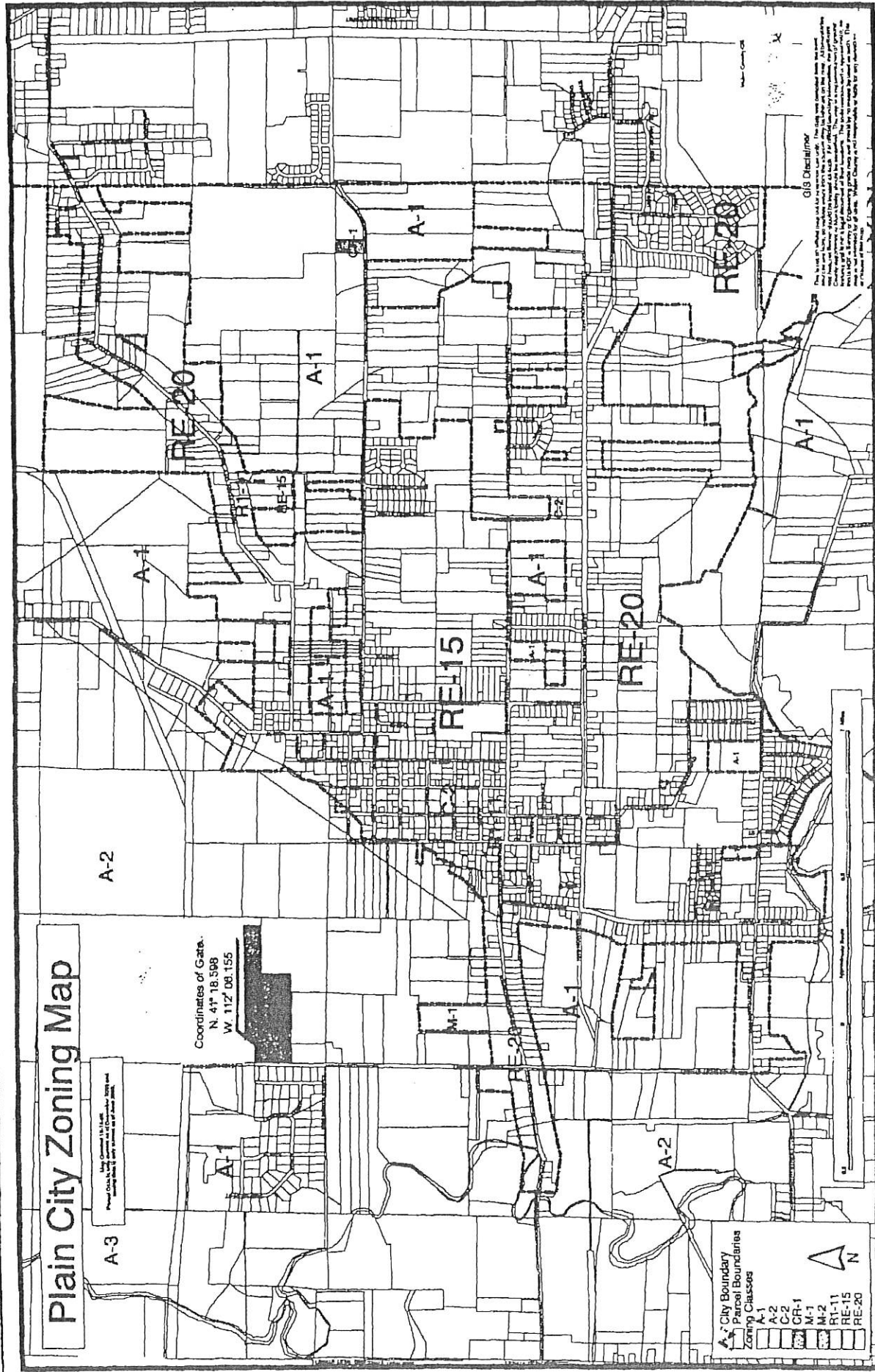

**GIS Disclaimer**  
 This map was prepared using GIS software. The City of Plain City is not responsible for any errors or omissions. The City of Plain City is not responsible for any damages or liabilities arising from the use of this map. The City of Plain City is not responsible for any damages or liabilities arising from the use of this map. The City of Plain City is not responsible for any damages or liabilities arising from the use of this map.

▲ City Boundary  
▭ Parcel Boundaries  
■ Zoning Classes

|  |       |
|--|-------|
|  | A-1   |
|  | A-2   |
|  | CR-1  |
|  | M-1   |
|  | M-2   |
|  | RT-11 |
|  | RE-15 |
|  | RE-20 |





# WARRANTY DEED

Lyman Harvey Cook and Dorothy Toone Cook, Husband and wife, GRANTOR  
of Plain City County of Weber State of Utah hereby CONVEY and  
WARRANT TO

Plain City Corporation

of Plain City County of Weber State of Utah, for the sum of  
Ten Dollars and other valuable considerations, ~~NOTARLY~~  
the following described tract of land in County, State of Utah

A part of the Southwest Quarter of Section 29, Township 7 North, Range 2 West,  
Salt Lake Meridian, U. S. Survey: Beginning at a point 450 feet East from the  
Southwest corner of the North one half of the Southwest Quarter of said Section  
29; thence East 870 feet; thence South 660 feet; thence East 330 feet; thence  
North 560 feet; thence East 850 feet; thence North 1300 feet; thence West 2050  
feet; thence South 1200 feet to beginning.

WITNESS the hand of said Grantor this 20th day of May A.D. 1969

Signed in the presence of

*Lyman Harvey Cook*  
*Dorothy Toone Cook*

STATE OF UTAH } ss. On the 23 day of May A.D. 1969  
County of Weber }

Personally appeared before me Lyman Harvey Cook and Dorothy Toone Cook, his wife,  
the signers of the within instrument, who duly acknowledged to me that they executed the same.

*Edna R. Bookland*  
NOTARY PUBLIC  
Residing at Ogden, Utah  
My Commission Expires Jan 16, 1972

Recording Data  
Fees \$10.00 Serial No. 15-377-500-1  
Entry No. 521097  
Platted  Indexed   
Recorded  Abstracted   
Compared  Page



COUNTY OF WEBER  
 FILED AND RECORDED FOR  
*County of Plain City*  
 Dec 15 12 53 PM '47  
 IN BOOK 280 OF Deeds  
 PAGE 545  
 DOROTHY D. CAMPBELL  
 COUNTY RECORDER  
*E. Charlotte Jacobs*

Book 280 Page 545



INDEXED  
 RECORDED  
 ABSTRACTED  
 FILED

Mail tax notice to Name

Address

# WARRANTY DEED

ELBERT J. NOYES and EDNA MAY NOYES, husband and wife, Grantor  
 of Plain City, County of Weber, State of Utah, hereby CONVEY and  
 WARRANT to TOWN OF PLAIN CITY, a public corporation,

of Plain City, County of Weber, State of Utah, for the sum of  
 TEN AND NO/100 ----- DOLLARS,  
 the following described tract of land in Weber County, State of Utah:

A part of the Southwest Quarter of the Southwest  
 Quarter of Section 29, in Township 7 North, Range 2 West,  
 Salt Lake Base and Meridian, United States Survey; Beginn-  
 ing at a point 40 rods North from the Southwest Corner of said  
 quarter section, and running thence North 40 rods; thence East  
 80 rods; thence South 40 rods; thence West 80 rods to the place  
 of beginning, containing 20.0 acres, more or less.

Subject to the taxes for the year 1947 and thereafter.

WITNESS the hand of said Grantor, this \_\_\_\_\_ day of June, A. D. 1947.

Signed in the presence of  
*Edna May Noyes*

*Elbert J. Noyes*  
*Edna May Noyes*

# PLAIN CITY LANDFILL DAILY REPORT

Wednesday

Saturday

**DATE** \_\_\_\_\_

**2022**

Training Y / N

|    | CARD # | BRUSH | GRASS | DEMOLITION | METAL | CONCRETE | CARDBOARD |
|----|--------|-------|-------|------------|-------|----------|-----------|
| 1  |        |       |       |            |       |          |           |
| 2  |        |       |       |            |       |          |           |
| 3  |        |       |       |            |       |          |           |
| 4  |        |       |       |            |       |          |           |
| 5  |        |       |       |            |       |          |           |
| 6  |        |       |       |            |       |          |           |
| 7  |        |       |       |            |       |          |           |
| 8  |        |       |       |            |       |          |           |
| 9  |        |       |       |            |       |          |           |
| 10 |        |       |       |            |       |          |           |
| 11 |        |       |       |            |       |          |           |
| 12 |        |       |       |            |       |          |           |
| 13 |        |       |       |            |       |          |           |
| 14 |        |       |       |            |       |          |           |
| 15 |        |       |       |            |       |          |           |
| 16 |        |       |       |            |       |          |           |
| 17 |        |       |       |            |       |          |           |
| 18 |        |       |       |            |       |          |           |
| 19 |        |       |       |            |       |          |           |
| 20 |        |       |       |            |       |          |           |
| 21 |        |       |       |            |       |          |           |
| 22 |        |       |       |            |       |          |           |
| 23 |        |       |       |            |       |          |           |
| 24 |        |       |       |            |       |          |           |
| 25 |        |       |       |            |       |          |           |
| 26 |        |       |       |            |       |          |           |
| 27 |        |       |       |            |       |          |           |
| 28 |        |       |       |            |       |          |           |
| 29 |        |       |       |            |       |          |           |
| 30 |        |       |       |            |       |          |           |
| 31 |        |       |       |            |       |          |           |
| 32 |        |       |       |            |       |          |           |
| 33 |        |       |       |            |       |          |           |
| 34 |        |       |       |            |       |          |           |
| 35 |        |       |       |            |       |          |           |
| 36 |        |       |       |            |       |          |           |
| 37 |        |       |       |            |       |          |           |
| 38 |        |       |       |            |       |          |           |
| 39 |        |       |       |            |       |          |           |
| 40 |        |       |       |            |       |          |           |
| 41 |        |       |       |            |       |          |           |
| 42 |        |       |       |            |       |          |           |
| 43 |        |       |       |            |       |          |           |
| 44 |        |       |       |            |       |          |           |
| 45 |        |       |       |            |       |          |           |
| 46 |        |       |       |            |       |          |           |
| 47 |        |       |       |            |       |          |           |
| 48 |        |       |       |            |       |          |           |
| 49 |        |       |       |            |       |          |           |
| 50 |        |       |       |            |       |          |           |

**OPERATOR MUST ENTER THE AMOUNT AND TYPE OF WASTE**

**Plain City Landfill**  
**Quarterly Facility Site Inspection Form**

Date \_\_\_\_\_

Time \_\_\_\_\_

Inspection Team \_\_\_\_\_

Surface Water Run-Off Controlled (not running off site) \_\_\_\_\_

Fence Conditions \_\_\_\_\_ Gate & Lock Conditions \_\_\_\_\_

Litter Control \_\_\_\_\_

Illegal Burning \_\_\_\_\_

Acceptable for burning: Yard Waste (tree limbs, branches, vegetative material). Get County Fire Marshal approval.  
Unacceptable for burning: treated wood, lumber, plywood, construction-type material.)

Illegal or Suspicious Dumping \_\_\_\_\_

Illegal Burying  
\_\_\_\_\_

Other Observations \_\_\_\_\_

List of Issues/Problems Corrected or Repaired \_\_\_\_\_

\_\_\_\_\_

\_\_\_\_\_

Name of Inspector(s) Signature(s) \_\_\_\_\_

\_\_\_\_\_

This form will be kept on site at the check-in office location indefinitely.

Plain City Landfill  
Training Form

Date of Training \_\_\_\_/\_\_\_\_/\_\_\_\_

Attendees Name/Signature

1. \_\_\_\_\_/\_\_\_\_\_

2. \_\_\_\_\_/\_\_\_\_\_

3. \_\_\_\_\_/\_\_\_\_\_

4. \_\_\_\_\_/\_\_\_\_\_

5. \_\_\_\_\_/\_\_\_\_\_

Training Topic(s)

1. \_\_\_\_\_ 4. \_\_\_\_\_

2. \_\_\_\_\_ 5. \_\_\_\_\_

3. \_\_\_\_\_ 6. \_\_\_\_\_

Instructors name/title

\_\_\_\_\_/\_\_\_\_\_

Plain City Landfill  
Post Closures Inspection Form

Inspector: \_\_\_\_\_

Date of Inspection: \_\_\_\_/\_\_\_\_/\_\_\_\_

**1. Cover:**

Overall condition of cover:    Poor    Fair    Good    Excellent

Describe problems if any and locations:

---

---

**2. Perimeter Fence and Access Gates:**

Access Gates:                                  Locked                  Unlocked

West entrance gate condition    Poor    Fair    Good    Excellent

Fence condition                                  Poor    Fair    Good    Excellent

**3. Compaction:**

Any settling observed:                  Yes                          No

Describe problems if any and locations:

---

---

**4. Drainage Systems:**

North drainage ditch condition:    Poor    Fair    Good    Excellent

Excessive erosion noted:                  Yes                          No

Describe problems if any and locations:

---